

在装配和操作本模型车前，敬请仔细阅读（使用说明书）
Please read and understand all instructions carefully before use.



1/18th Scale Electric 4x4 Drift Cars

Item No: 2192



14+
YEARS

Item No: 2193



Item No: 2195



Full Assembled RTR

**整车组装
入手即玩!**

1/18 电动四驱漂移

Disconnect and take out the battery pack from the vehicle when not in use. This will prevent damage from a leaking rechargeable battery pack. To prolong battery life, do not enable the vehicle to be used to a standstill resulting in the battery being completely drained. Fully charge the battery pack before each use. Do not leave battery pack uncharged for a long period of time. Store the battery pack in a dry, clean and cool condition.

注意：电池电力不足时，请勿操作模型车，应该及时充电。长时间不使用，请将电池取出！
请先将电池从车身内取出，再进行充电操作！

- This product is not a toy. It is not intended for operators under 14 years. Adult's supervision is a must.
- 本产品为无线电遥控模型并非玩具！本产品只供14岁及以上人员使用。14岁以下儿童必须在大人监护指导下操作模型车。
- This manual is subject to change without prior notice. Images may vary from the actual product.
- 为求产品持续改进，本说明书可能不预先通知而更改！本公司保留对说明书内容及图形修改的权利。

Caution

- 1) Please read and understand the manual before using, assembling, and/or disassembling.
- 2) This product is not a toy, it is a high powered RC model, which is not intended for operators under 14 years of age.
- 3) Children less than 14 years old must not operate this product unless they are closely supervised by an adult.
- 4) Fully charge the battery pack before use. Be sure to disconnect and remove the batteries from both the transmitter and the car when not in use.
- 5) Do not attempt to run the product while low on battery power. Fully charge the battery pack before use. Stop driving immediately when slow running speed is observed. Failure to do such can over drain the pack and cause damage.

General Safety Information:

1. This manual is subject to change without prior notification.
2. This product is NOT a toy, and not intended for users under 14 years of age, unless closely supervised by an adult.
3. The specifications and images in the manual may vary from the actual product.
4. Operate this vehicle with due care and be always a good driver which is attentive to others.
5. Under no circumstances SHOULD the user operate the vehicle in crowds of people. Serious injury could result.
6. Never operate the vehicle on public streets or in public areas. This could cause traffic accidents, personal injury, and/or property damage. This vehicle is ONLY be driven on the open track which is for RC cars.
7. Do NOT use this vehicle to chase pets or other animals.
8. The receiver, steering servo and other electronics installed in this vehicle are merely splash water-resistant. Do not immerse this vehicle into water.
9. Regularly checking on the transmitter (radio controller) power is very important. Remove the batteries from the transmitter (radio controller) when not in use. Replace with fresh batteries if necessary. NEVER run this vehicle with low power from the transmitter.
10. When this vehicle becomes stuck, do NOT force on throttle. Failure to do so could cause abrupt damage to the motor and/or the ESC (Electronic Speed Controller). Check and clean the obstacles before running again.
11. Before running this vehicle check if the battery, wiring, and plugs are loose.
12. Be careful not to touch any moving parts when servicing or operating this vehicle.
13. To prevent excessive RPM from damaging the motor, and/or the drive-train components, we suggest reducing the throttle while performing in the air during jumps.
14. Never attempt to re-assemble motor, ESC, and receiver as these have been precisely calibrated at factory.
15. Always apply the factory optional/tooling parts to this vehicle.
16. To upgrade this vehicle requires the user to upgrade the entire radio/driving system (such as motor, ESC, receiver and so forth.) They should be strictly matched with factory components.
17. To run this vehicle, turn on the transmitter (radio controller) first and then the receiver.
18. To stop running this vehicle, turn off the receiver first, and then the transmitter.
19. Straighten the receiver antenna (if it comes with this vehicle) for best receiving performance. Never cut the receiver antenna, otherwise it could lose control of the vehicle.

操作练习

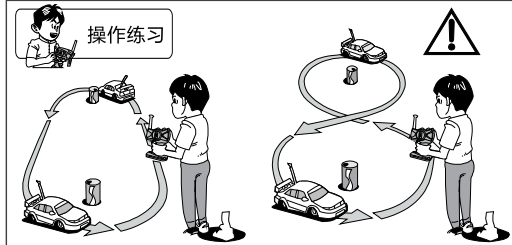

对于初学者而言，初步了解模型车相关基本操作后，都迫不及待地尝试操作。我们建议操作者多加练习，选择简单的场地（如图所示），首先选择低速行驶模型车，其目的是熟悉模型车转向、油门、刹车控制，直到熟练后方能尝试高速行驶，或更换复杂场地。

安全使用注意事项

为了安全使用本产品，请注意以下安全事项：

- 本产品为无线电遥控模型并非玩具！
- 本模型车只供14岁及以上人员使用。14岁以下儿童须在大人指导下操作模型车。为了使您更好享受到模型车带来的乐趣，在操作前须完成一些必要的组装和调试。
- 产品在出厂前已经完全装配好，切勿擅自更改模型配置，升级请选用原厂配置。
- 请不要在公路上和其它拥挤的区域操作模型，以避免发生意外事故。
- 请不要在水坑，粗毛地毯、沙地或满是灰土的地方操作模型车以免损坏模型车或发生危险。
- 擅自对本模型车进行升级改装后所造成的故障，不是本产品的质量问題，工厂不承担连带责任。
- 使用刀具镊子和螺丝刀时应小心，以免划伤身体。
- 请正确使用电池和可充电电池组，否则可能会损坏模型车和遥控设备。
- 切勿自行拆卸电池，充电器，电路板等电子设备。
- 由于本模型有细小零件，组装时必须远离幼童，且不用时应将产品存放在小孩不可触及的地方，不使用时，请按顺序关闭模型车和遥控器电源。
- 长时间不使用时，应从模型车和遥控器内取出电池，以防电池漏液发生危险。
- 请注意，不要将电池反装或分解，否则可能会损坏模型车和遥控器或发生危险。

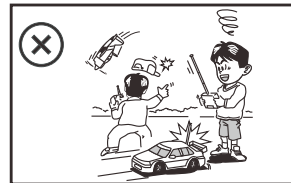
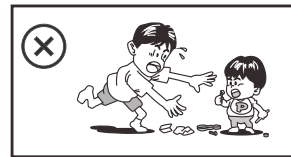
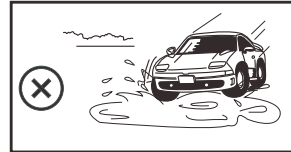
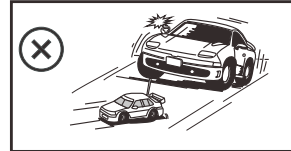

Practice Required:

Beginners should start slowly. Keep practicing until you feel comfortable with steering, throttle, and brakes. Once you feel comfortable driving the vehicle try a different terrain and speed until you have mastered the basics.

Once you have learned the basics, try different patterns and tracks to improve your skills.

Add a friend for a race or try to beat your best times!

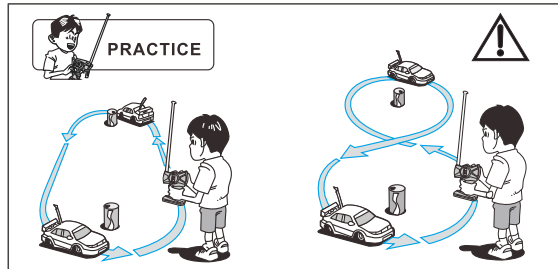

2.4GHz Transmitter Introduction:



Do not move the trigger and steering wheel while the transmitter is attempting to bind with the receiver. Please operate only after the binding process is completed.

- 1) Power Button (On/Off)
- 2) Aux. Button
(For instance, light ON/OFF)
- 3) Steering Trim
- 4) Throttle Trigger
- 5) Steering Wheel
- 6) Steering Reverse Switch
- 7) Speed Switch (Slow/Fast)

2-in-1 ESC/Receiver



This ESC/Receiver is **ONLY compatible** with a 7.4V (2S) Li-ion or Li-Po battery pack.
Modification and abuse will lead to serious damage.

1. Power Switch
Press and hold it for 2-3 seconds to switch on or off.
2. Motor Connector Slot
3. Servo Plug Slot
4. Aux. Slot (For instance, for car lights)

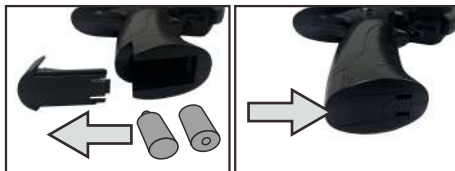

Slide and remove the battery cover from the transmitter. Install two AA size batteries (1.5V each) and make sure to align the polarities correctly. Replace the battery cover securely. Use batteries of the same brand and remove them when the transmitter is not in use. Always ensure sufficient battery power before operating the transmitter.

If the transmitter blinks slowly with 2 flashes, it's time to replace with new batteries.

2.4GHz 遥控/接收功能介绍

2.4GHz 遥控



- 1) 电源开关
- 2) AUX.辅助通道钮
(如: 车灯开关)
- 3) 转向微调
- 4) 油门扳机
- 5) 方向控制轮
- 6) 方向正、反切换开关
- 7) 快/慢速切换

用手推开电池盖，按电池仓内正负标识安装两个AA电池，再插入并推紧电池盖。(如图示)

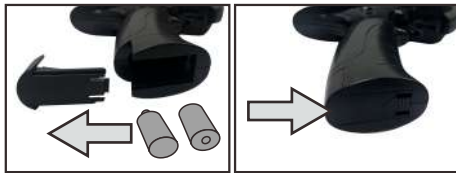

注意事项:

1. 请使用同种型号的电池。新旧电池不能混用。若长时间不使用，请将遥控器和模型车内电池取出。
2. 不正确的电池安装方式容易引起电池漏液。当处理废电池时，请将废电池放入环保垃圾箱内。
3. 发射机电池接触片有可能出现局部氧化现象，可用小刀轻轻地刮去被氧化部位的铁锈。

一体式接收/电调

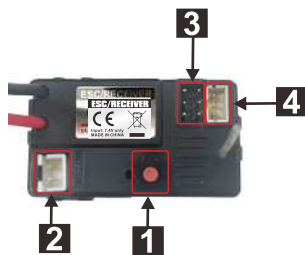

接收/电调电源供电仅限使用7.4v(2S)锂电池。
擅自改装或滥用会导致损坏电路系统。

- 1) 电源开关: 长按2-3秒开机或关机
- 2) 马达插口
- 3) 舵机插口: (3线舵机)
- 4) AUX通道: (如有配车灯)

Starting Driving:

1) Switch on the Transmitter:

Press and hold the Power button on the transmitter for 2 seconds to switch on the transmitter.

Do not move the trigger and steering wheel while the transmitter is waiting for binding.



Press and hold it for 2 seconds to switch on the power.

2) Switch on the ESC/Receiver:

Press and hold the Power button on the ESC/Receiver for 2-3 seconds to switch on the car. It will take a few seconds before the LEDs (on transmitter and ESC/Receiver) stop blinking and become bright on, which indicates the car has been bound with the transmitter. Binding operation may fail in low battery power.

Please stop to charge the battery pack once the car jerks or move slowly.

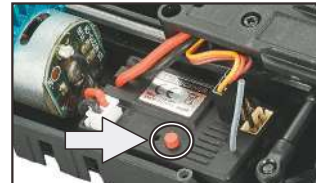

Press and hold it for 2-3 seconds to switch on the power.

3) Checking the steering performance by turning the steering wheel:

TURN LEFT



TURN RIGHT

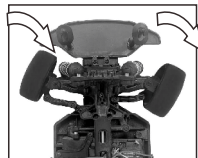

A) Turn the steering wheel to the left, and the car turns left.

B) Turn the steering wheel to the right, and the car turns right.

4) Throttle Control:



PULL IT BACK
CENTER

PUSH IT FORWARD



Pull the trigger to accelerate, release it to slow the speed, and push to brake. Pull it to the Center Position and push it again to go reverse.

操作模型车

每次使用前, 请将模型车电池充满, 并检查遥控器电量是否充足。当遥控器持续2次慢闪时, 提示电量不足, 请及时更换电池。

1、遥控器 (开)



长按2秒打开遥控器电源

2、模型车 (开)



长按2-3秒开机

先长按2秒遥控器电源开关, 打开遥控器电源, 遥控器指示灯闪烁, 提示正搜索需要对码的模型车, 接着长按2-3秒模型车电源开关, 此时遥控器指示灯转为长亮, 提示对码成功。如果指示灯始终处于闪烁状态, 提示未搜索到模型车, 请检查模型车指示灯是否亮起。模型车指示灯闪烁说明处于对码状态, 对码未成功。指示灯不亮说明电池未接通, 检查线路是否破损或更换电池。

注意: 切勿手扣扳机来进行对码操作, 以免系统输入错误的油门指令! 对码成功后, 方能操作扳机和转向轮!

3、方向操作

旋转遥控器方向盘, 模型车的前轮动作应与遥控器的操作指令一致。

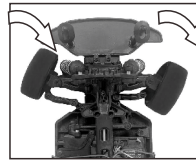
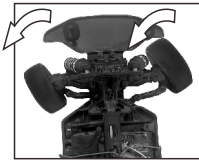

遥控方向轮向左, 模型车左转弯。 遥控方向轮向右, 模型车右转弯。

4、油门操作

用手扣下遥控器扳机, 模型车应向前行驶, 从前进位置迅速撑开扳机, 模型车处于刹车状态, 使扳机回到中点再次撑开为后退。



5) Steering Trim Knob:

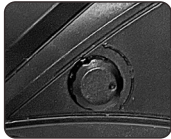

STEERING TRIM



It is used to set the steering neutral point on front wheels. If the front wheels on the vehicle veer in one direction while the steering wheel is centered, turn this knob in the opposite direction until the vehicle drives straight.

6) Speed Switch Knob:

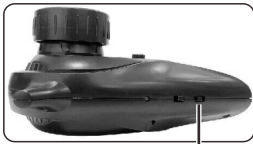

SPEED SWITCH



This switch offers two speed settings: Slow and Fast. However, we recommend beginners to start with the slow speed option before switching to high-speed running.

7) Steering Direction Reverse Switch:

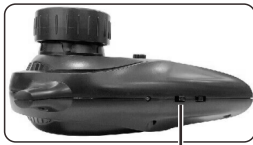

STEERING REVERSE

If the vehicle turns right when you steer left, flip "Steering Reverse" switch.
If the vehicle turns left when you steer right, flip "Steering Reverse" switch.

Stopping Driving:

- 1) Press and hold the Power Button for 2-3 seconds to switch off the vehicle power.
- 2) Press and hold the Power Button on the transmitter to switch off the transmitter power.
- 3) Disconnect and remove the battery pack from the vehicle if the vehicle is not in use.



Press and hold it for 2-3 seconds to switch on the power.

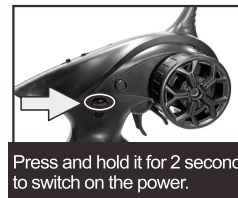

Press and hold it for 2 seconds to switch on the power.

5、方向微调

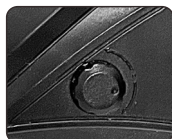

方向微调



将模型车放置在工作台(四轮悬空状态) 慢慢地调节方向微调直到模型车前轮中心竖直向前 (转向中心点位置设定完成, 模型车在行驶中, 左/右转向控制量均匀)

6、油门限速钮

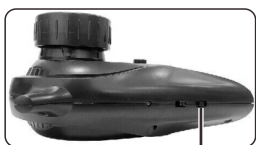

速度控制钮



速度开关提供了两个速度档位：慢速和快速。然而，我们建议初学者先从慢速开始，然后再尝试高速行驶。

7、方向正、反切换开关

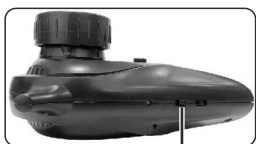

方向正、反切换开关

此切换开关可使模型车前轮左/右转向调转方向。

关闭模型车和遥控

1、模型车（关）



长按2-3秒关机

2、遥控器（关）



长按2秒关闭遥控器电源

若长时间不使用,请取出模型车电池,存放于干燥阴凉区域。

Charging The Battery Pack:

! WARNING!

- Please fully charge the battery before each use.
- Do not leave the battery uncharged for a long time.
- Disconnect and take out the battery from the vehicle before charging. Do not charge the battery if it is still in the vehicle.
- Keep out of children's reach when charging. Children are not allowed to charge the battery unless they are closely supervised by adults.
- Do not leave unattended while charging.
- Do not fully discharge the battery while driving the vehicle.
- Do not charge the battery in wet or humid conditions.
- Charge only in dry conditions.
- Do not use damaged or leaky batteries.

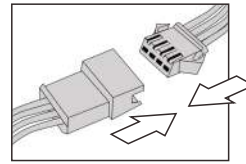
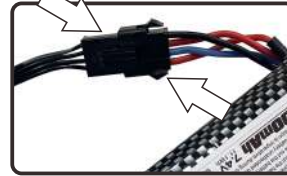

- Connect the battery connector with the USB charging plug.
- Insert the USB into the USB charging slot.
- The LED on the USB is bright while charging.
- The LED on the USB will go off after the battery has been fully charged.

It will take 2.5 hours before a 7.4V, 800mAh battery is fully charged.

A phone charger with an output of 5V, 2A can be applied to cut down charging time.
Do not attempt to connect the USB charger to a phone charger which has an output greater than 5V.

模型车电池充电

- 严禁使用非原厂配置电池组和usb充电线。对于使用非原厂提供的充电器进行充电所造成的一切后果，厂家将不予负责。
- 充电时请将电池和充电器放置在空旷处周围无易燃、可燃物的地面。请留意充电过程，以防发生意外。
- 请断开连接并从模型车内取出电池后，才能对电池进行充电。
- 请将电池存放在儿童接触不到的地方。如果儿童不小心吞咽零部件，应立即寻求医疗救助。
- 存放电池的环境应保持干燥。请勿将电池置于水中或者可能会漏水的地方。
- 禁止机械撞击、碾压、刺穿电池，禁止将电池跌落或人为短路。



连接USB充电线，将USB线插入USB充电设备口，进行充电。

7.4V, 800mAh 电池的充电时间约为2.5小时。

USB 指示灯说明：

- 1) 电池充电时，红灯常亮，提示电池正在正常充电。
- 2) 电池充满电后，红灯熄灭。

*充电故障：若红灯一直处在不亮的状态下，则提示电池无法充电，电池可能长期闲置或过放而损坏，请检查连接或更换新电池，或更换USB充电线。

注意：当模型车速度明显下降时，建议立刻对模型车电池充电，以免电池过放而损伤电池。

若电池长时间闲置，需定期2周左右充电。可通过连接手机充电配置插头（标准5V，2A）进行充电操作可以缩短充电时间。切勿使用电压电流超过5V，2A的手机充电适配头，避免过流充电损伤电池。

Maintenance:

We strongly recommend that you check and maintain the vehicle after use. Please read and understand the list below which will facilitate you.

- Disconnect and remove the batteries from the car and the radio controller when not in use.
- Do not leave the rechargeable battery pack uncharged or fully charged for a long time.
- Check if there is any obvious damage after each use.
- If the vehicle runs noisily check to see if there is any broken or slipped gears and check if there is a clogged drive train.
- Check if the wheels are well tightened after use.
- Check if there are any loose screws in the chassis.
- Check if there are not frayed, damaged, loosened wires, or connectors.
- Check if the steering servo is in good order. It may wear out over time and require replacement.
- Check if there are any objects getting twisted in the drive train. Replace them if necessary.
- Check the motor and motor wires after use. Never attempt to re-assemble the motor.
- Clean the car body and chassis with a soft lint-free cloth.
- Store the vehicle in a clean, cool, and dry place out of children's reach.

Troubleshooting:

A. The vehicle does not work at all:

- 1) Check to ensure that radio controller and car are switched on.
- 2) Check if there are damaged parts/wires/connectors, repair or replace if necessary.
- 3) Car battery is flat. Charge the battery pack.

B. The vehicle runs slowly:

- 1) Car battery is flat. Charge the battery pack.
- 2) Check if the vehicle is properly geared and no dirty or stripped gears are found. Make sure there is a reliable gear mesh for motor pinion and the spur gear.
- 3) Check if there is something stopping the moving parts and clean them immediately.

C. The throttle works but not the steering:

- 1) Check if the servo feels jammed, and try centering it gently if it is the case.
- 2) Check if the servo link is loose or the servo breaks. Repair or replace if needed.

D. It steers, but throttle is uncontrollable:

- 1) Check if there are damaged parts in the overall drive train.
- 2) Check the battery power both for radio controller and the car.

E. The vehicle runs noisily:

- 1) Check gear mesh between spur gear and motor pinion.
- 2) Check if there are stripped and/or dirty gears.
- 3) Check if there are some parts getting damaged in the overall drive train.

F. The vehicle is found one direction's steering travel is not same to the other.

Please tune the Steering Trim until Steering Center Point is fixed.

G. Not able to charge the batteries:

Check if either the charger or the batteries is damaged, or batteries are over-discharged.

模型车的保养

1. 若长时间不使用，请将模型车和遥控内电池取出。
2. 每次使用前，仔细检查模型车电路接线是否紧固，没有脱落的接头。仔细检查车轮是否紧固，松垮的车轮会造成传动轴，车轮杯或轮座等部件的过度磨损。
3. 闲置的电池需要充电后（充至50-60%电量）保存于干燥，阴凉处，避免儿童触及。
4. 每次使用后，请仔细检查模型车各部件是否完整，及时维修或更换。用细毛刷清扫模型车内的沙土，泥灰等污垢，然后用软布擦拭干净。

故障排查与解决方案

	故障现象	故障排查	解决方案
遥控器	1.电源指示灯不亮	电池没电或电池安装错误	更换新的电池或者检查电池正负极
	2.电源指示灯频率式慢闪	电池电量不足	更换新的电池
	3.指示灯正常亮起,但是无功能,无法操控车辆。	周围可能有其它正在运行的电子产品导致的遥控频率干扰	重启模型车和遥控器或更换场地使用
		模型车电池电量不足	请及时充电或更换模型车电池
4.模型车在没有使用遥控的情况下自行运转	电位器偏离中位	重启模型车和遥控器。 对码时切勿手扣扳机！	
模型车	1.接通电源后指示灯不亮	电池没电或电池过放而损坏,或电路接线破损	更换为已充电的电池,检查电池和线路是否损坏
	2.转向异常或失灵	检查是否有杂物阻塞转向结构,或转向部件或舵机已损坏	检查所有部件,更换任何损坏的或磨损的部件
	3.能转向,但无法前进或后退	1)电池电力不足	更换为已充电的电池
		2)传动部件损坏或被杂物阻塞	清理与更换部件
3)电调功能异常		更换电调	
4.模型车行驶时噪音大	检查是否有杂物阻塞传动部件,或传动部件损坏或脱落,检查齿轮啮合度,检查并分析差速器和大齿轮是否已出现扫齿,崩牙等现象	及时更换掉已损坏的齿轮,传动轴,传动接杯或差速器。	

PART LIST-1 配件表-1

29000	29001	29002	29003
 车底盘 Chassis	 二楼板+齿轮箱上盖 Upper Deck+Gear Box Top Housing	 2195专用 (for 2195 only) 避震架(前/后)+后车壳支柱 Shock Towers+Rear Body Posts	 2195专用 (for 2195 only) 防撞架(前/后)+前车壳支柱 Bumpers+Front Body Posts
29004	29005	29006	29007
 摆臂+转向拉杆+舵机拉杆 Suspension Arms/Links	 前/后传动轴 Front/Rear Universal Drive Shafts	 转向杯+后轮座 Steering Hubs + Rear Hubs	 舵机压板/缓冲+转向套件 Servo Top Plate/Servo Saver+ Steering Plates
29008	29009	29010	29011
 齿轮全套 Gears Complete	 2195专用 (for 2195 only) 避震器 4P Shock Absorbers 4P	 2192 /2193专用 (for 2192/2193 only) 防撞架(前/后)+前车壳支柱 Bumpers+Front Body Posts	 2192 /2193专用 (for 2192/2193 only) 前防撞海绵 Front Bumper Sponge
29015	29016	29017	29030
 2192 /2193专用 (for 2192/2193 only) 避震器 4P Shock Absorbers 4P	 2192 /2193专用 (for 2192/2193 only) 避震架(前/后)+后车壳支柱 Shock Towers+Rear Body Posts	 漂移车轮总成(2P) Drift Wheels Complete (2P)	 马达散热片 Motor Heat Sink
29021	29022	29023	29024
 中传动轴 Center Drive Shaft	 摆臂螺栓 4P Suspension Arm Hinge Bolts 4P	 主臂轴 4P Suspension Arm Hinge Pins 4P	 轮毂装饰圈 8P Wheel Rings 8P

PART LIST-2 配件表-2

<p>29025</p>  <p>车壳支柱横销 8P Body Post Pins 1.5x10mm 8P</p>	<p>29026</p>  <p>370马达+马达齿 Motor 370+Motor Pinion</p>	<p>29027</p>  <p>3线舵机 (9g) 3-Wire 9g Servo</p>	<p>29028</p>  <p>2合1电调/接收(4P头) ESC/Receiver</p>
<p>29029</p>  <p>Li-ion 电池 7.4V, 800mAh Li-ion Battery Pack 7.4V, 800mAh</p>	<p>H013</p>  <p>球头(3.8x9.9mm) 8P Ball Stud. (3.8x9.9mm) 8P</p>	<p>H179</p>  <p>车壳扣(4P) Body Clips 4P</p>	<p>H180</p>  <p>灯架扣(8P) Light Brace Clips 8P</p>
<p>H032</p>  <p>4*7*2mm 滚珠轴承(6P) Ball Bearings 6P</p>	<p>635953</p>  <p>6.35*9.53*3.17mm 滚珠轴承(8P) Ball Bearings 8P</p>	<p>16804</p>  <p>8*12*3.5mm 滚珠轴承(8P) Ball Bearings 8P</p>	<p>T10014</p>  <p>USB 充电线(4P头) USB Charger</p>
<p>16050</p>  <p>电池扎带 Battery Strap</p>	<p>29040</p>  <p>车壳 (2195专用) Car Body (For 2195)</p>	<p>29041</p>  <p>车壳 (2192专用) Car Body (For 2192)</p>	<p>29045</p>  <p>车壳 (2193专用) Car Body (For 2193)</p>
<p>29200</p>  <p>车灯架 (2192专用) Car Light Braces (for 2192 only)</p>	<p>29201</p>  <p>车灯 (2192专用) Car Light (for 2192 only)</p>	<p>29202</p>  <p>车灯架 (2193专用) Car Light Braces (for 2193 only)</p>	<p>29203</p>  <p>车灯 (2193专用) Car Light (for 2193 only)</p>

PART LIST-3 配件表-3

S037	S059	S070	S128
 <p>沉头自攻牙螺丝 Countersunk Self Tapping Screws KBHO2.3*10mm (12P)</p>	 <p>盘头机牙螺丝 Pan Head Self Tapping Screws BMHO3*8mm (12P)</p>	 <p>盘头自攻牙螺丝 Pan Head Self Tapping Screws PBHO2*8mm (12P)</p>	 <p>沉头自攻牙螺丝 Countersunk Self Tapping Screws KBHO2.3*6mm (12P)</p>
S185	S202	S240	18051
 <p>盘头自攻牙螺丝 Pan Head Self Tapping Screws PBHO2.3*10mm (12P)</p>	 <p>沉头自攻牙螺丝 Countersunk Self Tapping Screws KBHO2*12mm (12P)</p>	 <p>法兰盘自攻牙螺丝 Flange Head Self Tapping Screws PWTHC2.3*12mm (12P)</p>	 <p>盘头自攻牙螺丝 Pan Head Self Tapping Screws PBHO2.3*7mm (12P)</p>

ASSEMBLY VIEW-1 组装图-1

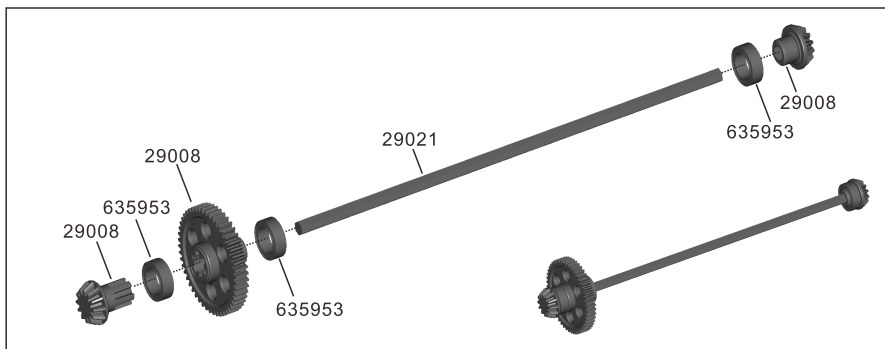
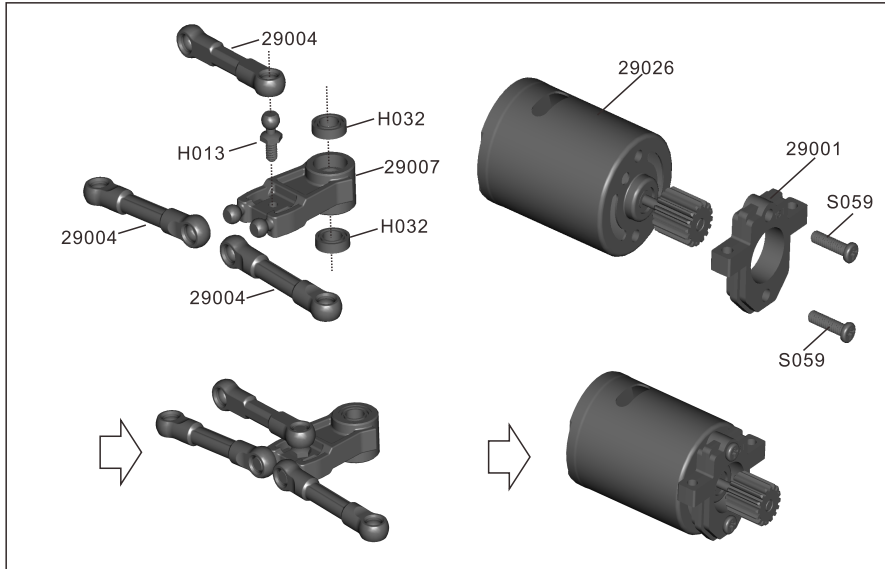
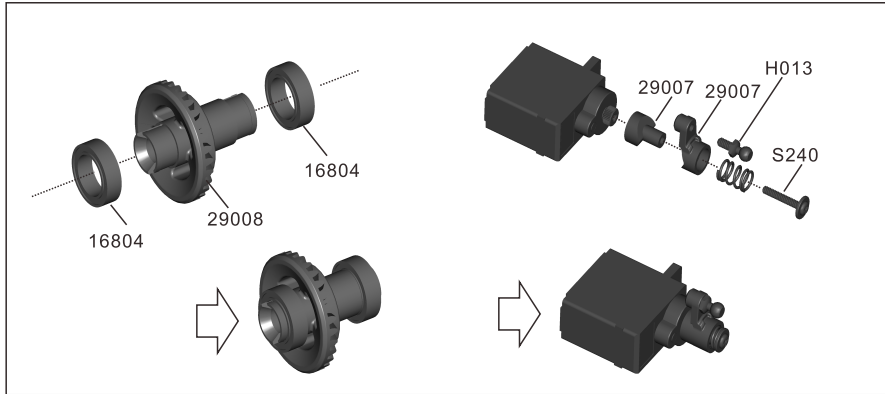

ASSEMBLY VIEW-2 组装图-2

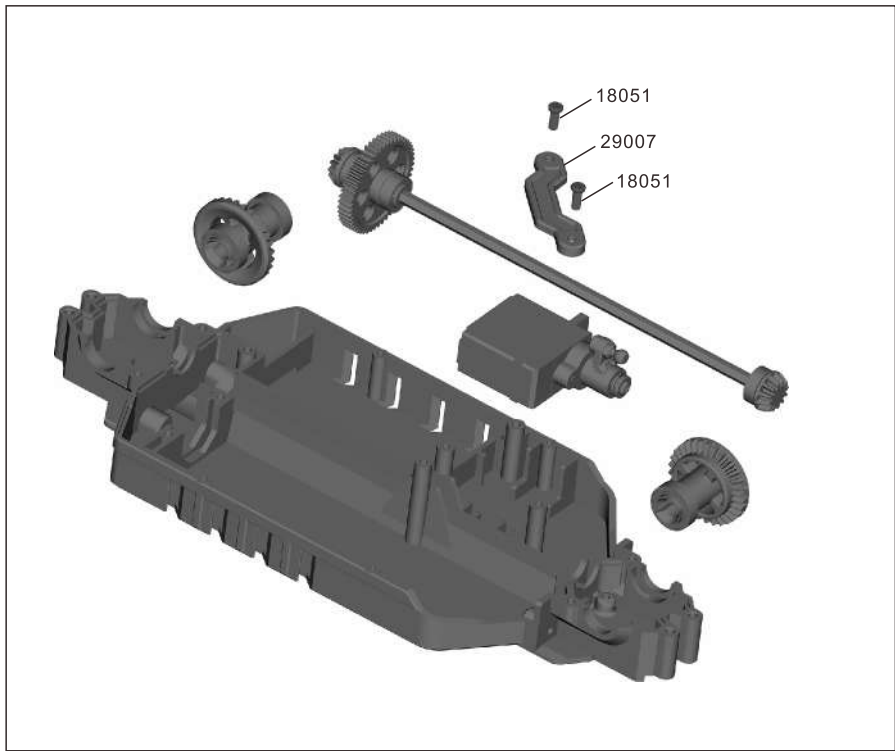
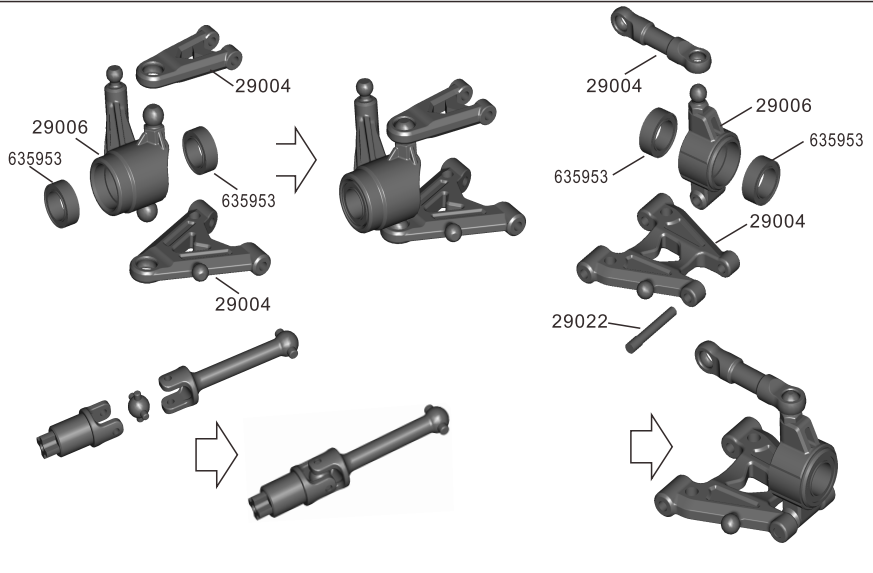

ASSEMBLY VIEW-3 组装图-3

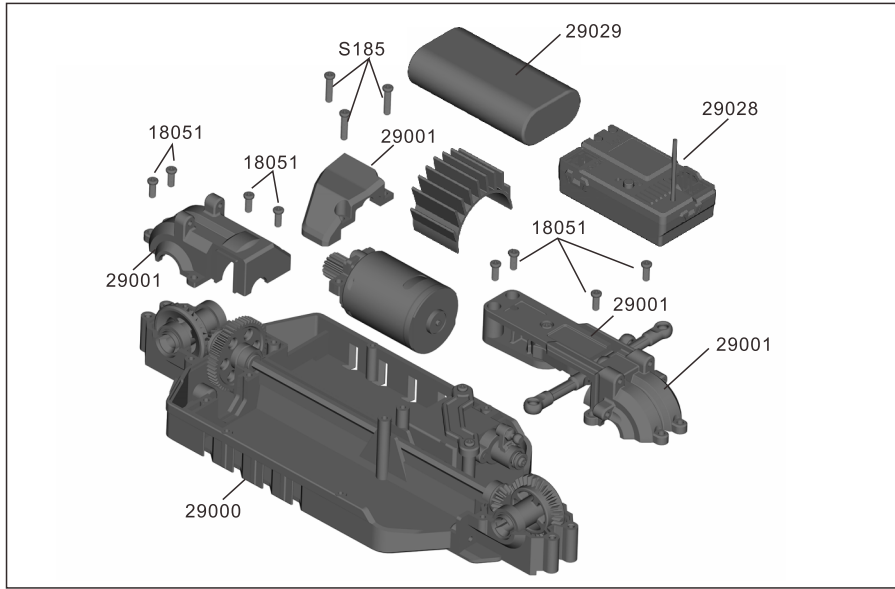

**Chassis Layout (2192/2193)
底盘车身装配 (2192/2193)**

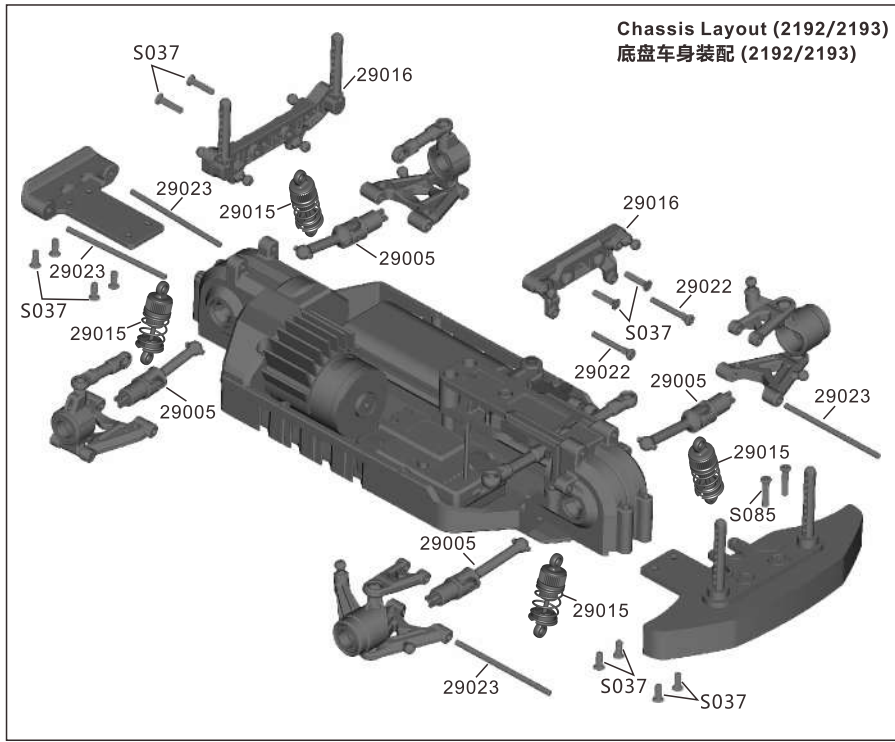

ASSEMBLY VIEW-4 组装图-4

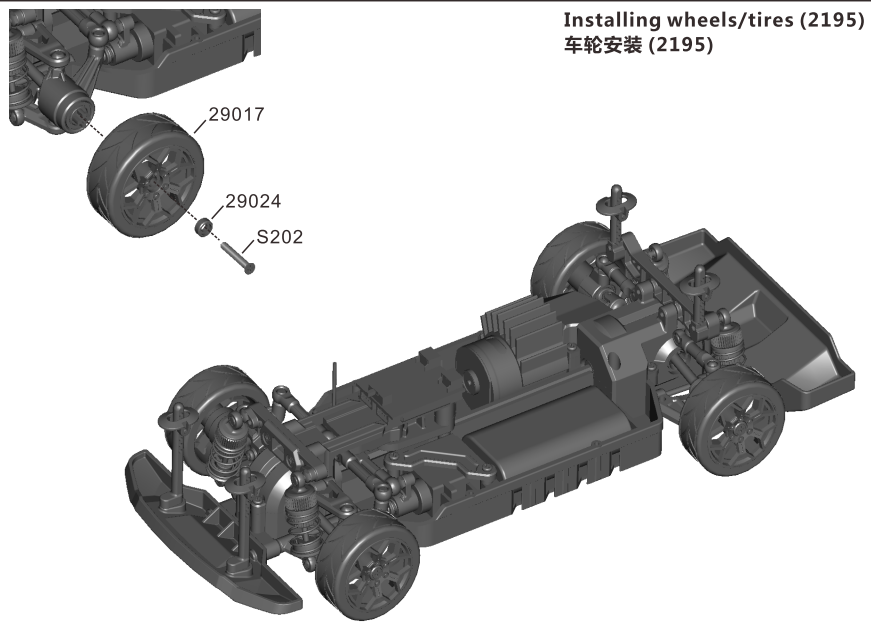
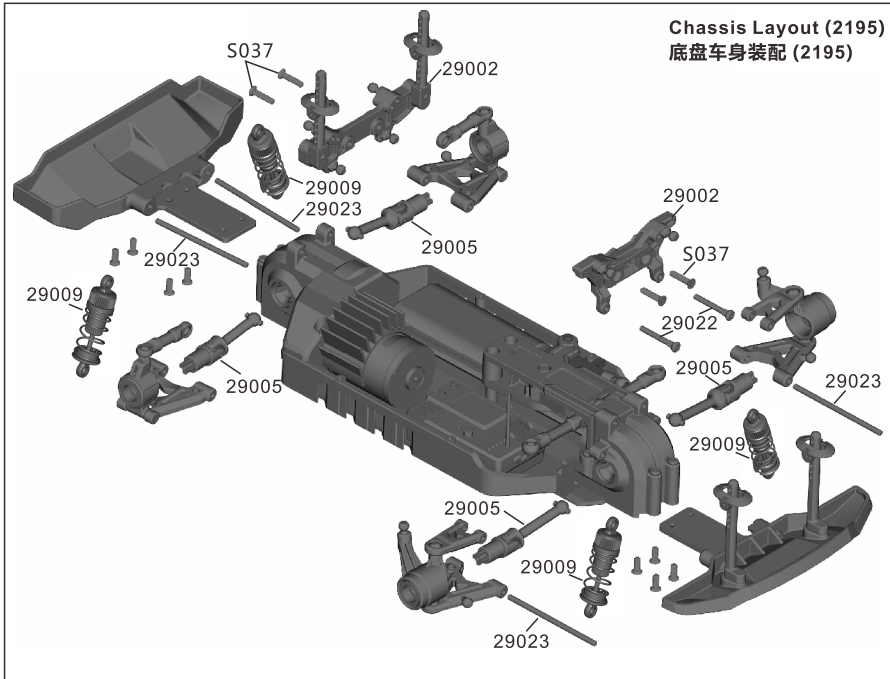

ASSEMBLY VIEW-5 组装图-5

Installing wheels/tires (2192/2193)
安装车轮 (2192/2193)

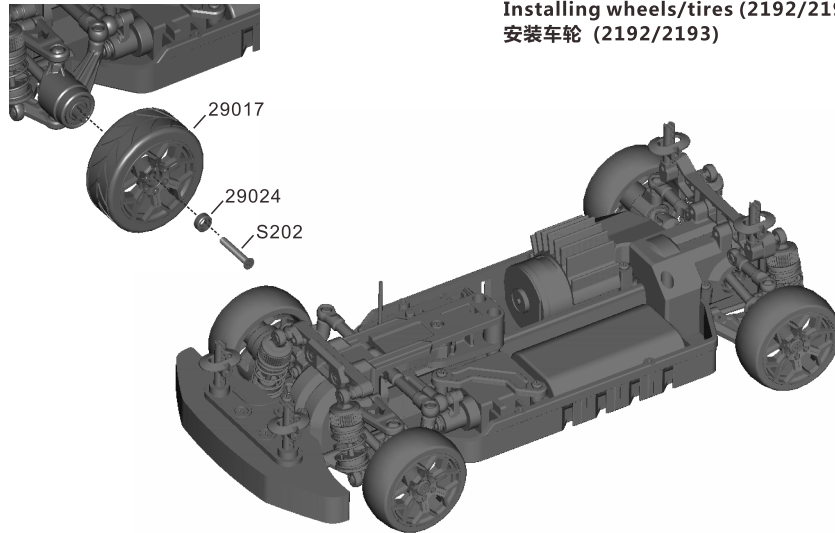

Installing light braces (2192)
安装灯架 (2192)

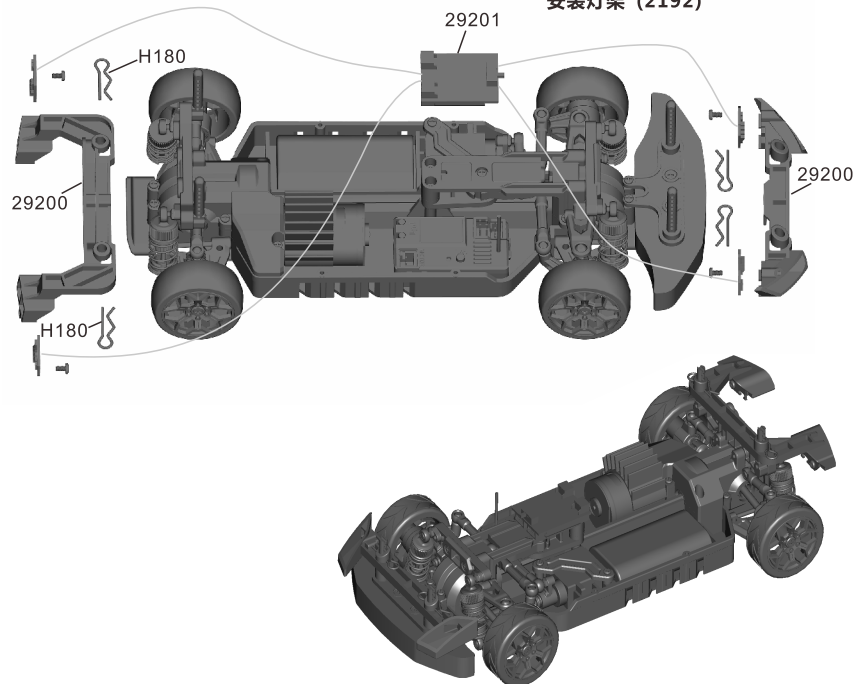

ASSEMBLY VIEW-6 组装图-6

Item No.: 2192

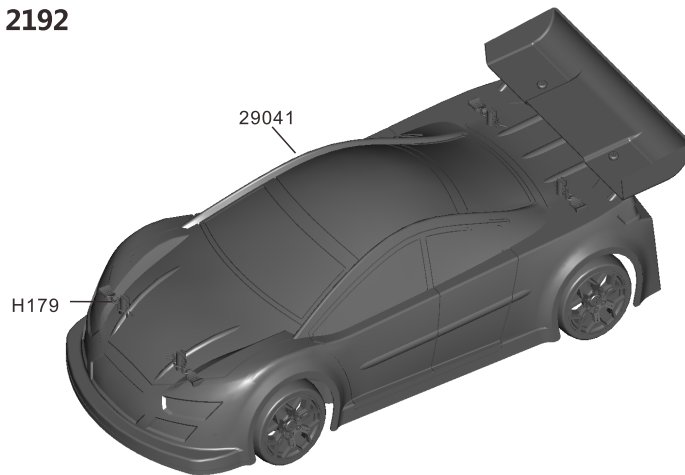

Installing light braces (2193)
安装灯架 (2193)

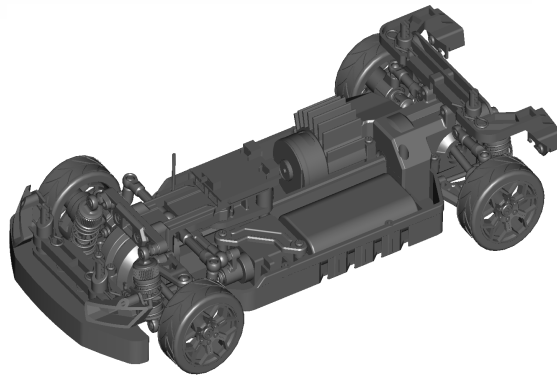
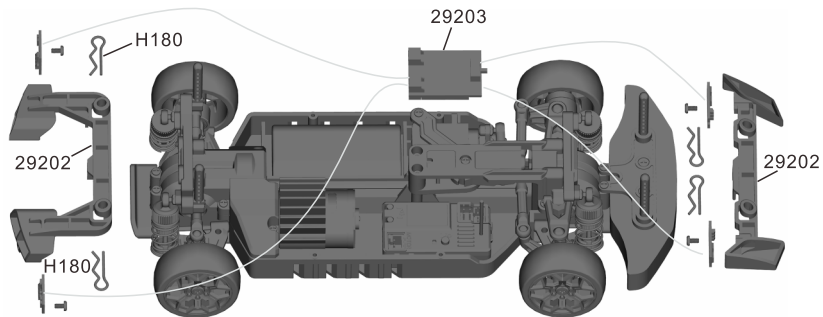

ASSEMBLY VIEW-7 组装图-7

Item No.: 2193

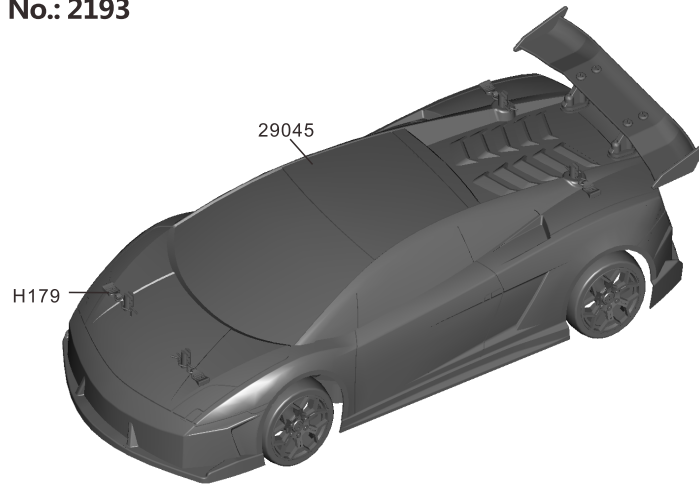

Item No.: 2195

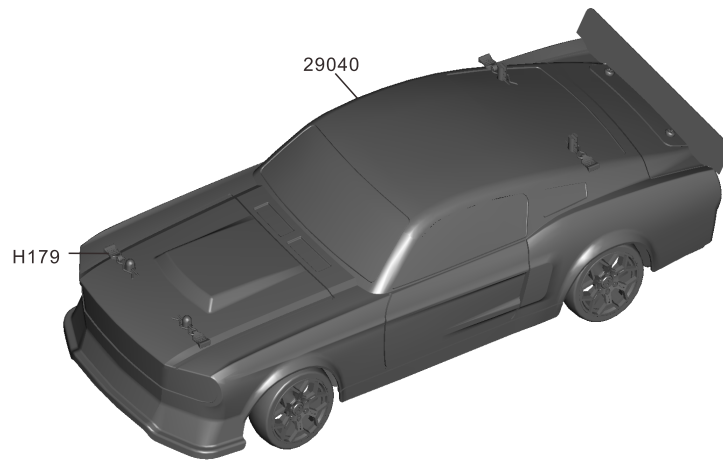

在装配和操作本模型车前，敬请仔细阅读（使用说明书）
Please read and understand all instructions carefully before use.

1/18 Electric 4x4 Drift Cars 1/18 电动四驱漂移

14+
YEARS

- This product is not a toy. It is not intended for operators under 14 years. Adult's supervision is a must.
- 本产品为无线电遥控模型并非玩具！本产品只供14岁及以上人员使用。14岁以下儿童必须在大人监护指导下操作模型车。
- This manual is subject to change without prior notice. Images may vary from the actual product.
- 为求产品持续改进，本说明书可能不预先通知而更改！本公司保留对说明书内容及图形修改的权利。